

NEW! Flavor Burst™ CC8 Soft Serve System

The **ONE-STEP** process to blend **CANDY** & confections into soft serve **CONES!**



Cookies & Creme

Milk Chocolate
m&m's
CHOCOLATE CANDIES

HEATH
MILK CHOCOLATE ENGLISH TOFFEE BITS

Made with Heath® Toffee Bar

FB CC8-08/26
Shown with Taylor Model C708
Printed in U.S.A 1/18/07

 ©2007 Flavor Burst Company. CrunchiCreme is a registered trademark of Flavor Burst Company. All other marks are property of their respective owners, used with permission. The Heath brand and trade dress are used under license. All rights reserved. UL & CE CERTIFICATIONS PENDING AT TIME OF PRINTING. POP-CC1000 R122106

PREMIUM SOFT SERVE

Flavor Burst™ CC8 Soft Serve System

The CC8 soft serve system uses a revolutionary process to mix many popular candies, nuts and other confections into soft serve as it's dispensed to create CrunchiCreme™. The CC8 is compatible with most soft serve freezers and is easy to operate. Simply select the flavors -- *or flavor combinations* -- from the electronic keypad and dispense the soft serve. (Flavor output and combination flavor timing are adjustable for flow, taste, and appearance.)

Model: FB CC8-08/26

Boxed Dimensions	in.	mm.
Width	28	712
Depth	18	458
Height	18	458
Total Cubic	5.25 cu. ft.	.15 cu. m.
Weights	lbs.	kgs.
Total Net	26	11.8
Total Crated	29	13.2
Electrical	Min. Circuit Amp Draw	
115v 50/60Hz	1	
230v 50/60Hz	1/2	

This model may also be available in other configurations. Please contact your local distributor for more information regarding specific product applications for this equipment. An ongoing commitment to better serve the Flavor Burst™ family of operators results in steady improvements to our many products. Therefore, specifications are subject to change without notice.

Features

Instant Delivery System creates 1-step delivery of finished product.

Variable Portioning enables operators to dispense any serving size directly into cup or cone.

Single-head System attaches to most popular soft serve freezers and accommodates soft serve and frozen yogurt product.

Product Overrun is maintained using a process that does not beat air out of the product, therefore maintaining product overrun and profit margins.

8-Flavor Carousel conveniently supplies up to 8 ingredients within the system.

Integrated Data Entry Panel serves as the primary operating station for selecting ingredients, maintenance functions and system warnings.

Extensive Flavor Selections (sold separately) are available from Flavor Burst Company with brands recognized around the world.

Easy-on Dispensing Modules simplify ingredient installation and changeover.

Modular Engineering provides quick disassembly & assembly for routine

Carousel & Component Microprocessor

NOTE: FIGURES IN PARENTHESES INDICATE MILLIMETERS.

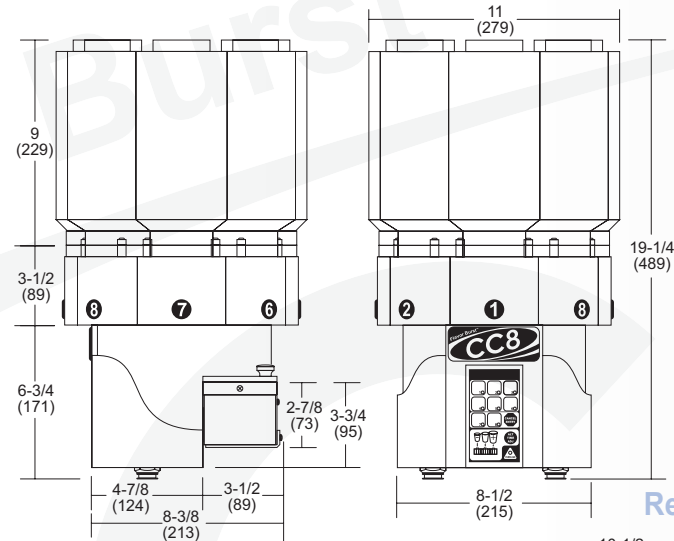

Blending Assembly

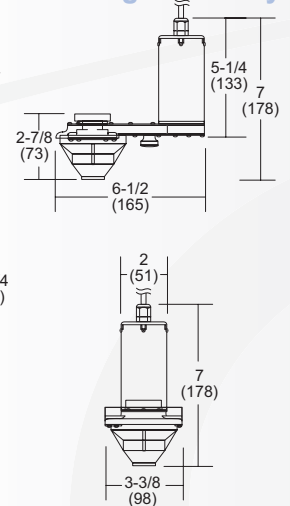

Remote Power Supply

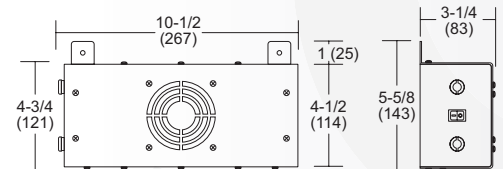

maintenance in only minutes a day and convenient trouble shooting.

Dispensing Agitators & Direct Drive Injector produce efficient, reliable and consistent distribution of ingredients.

Remote Microprocessor provides extensive functionality such as portion control or the ability to combine ingredients within the system.

Specifications

Dry Food Product ingredients should be approved by Flavor Burst Company to ensure compatibility and optimum performance. The size guide below may be used for quick reference for compatibility:

Minimum .0312 in.
Maximum .3500 in. Actual Sizes

CAUTION: BECAUSE ALL INGREDIENTS ARE DISPENSED THROUGH A COMMON ORIFICE, ALL FINISHED PRODUCTS SHOULD BE CONSIDERED AS CONTAINING NUTS.

Single Electrical Connection is required. Contact your local distributor for additional specifications in accordance with local codes.

Accessories

- Model Specific Adapter Kit
- Extension Cables
- Cooling Hood
- Model-specific Mounting Bracket
- & More...



Flavor Burst Company
800-264-3528 www.flavorburst.com

Call Your Local Distributor Today!

CrunchiCreme™

NEW!

An optional Cooling Hood keeps CC8 ingredients at a manageable temperature when external temperatures could otherwise cause the ingredients to melt and clog the system.

Optional Cooling Hood

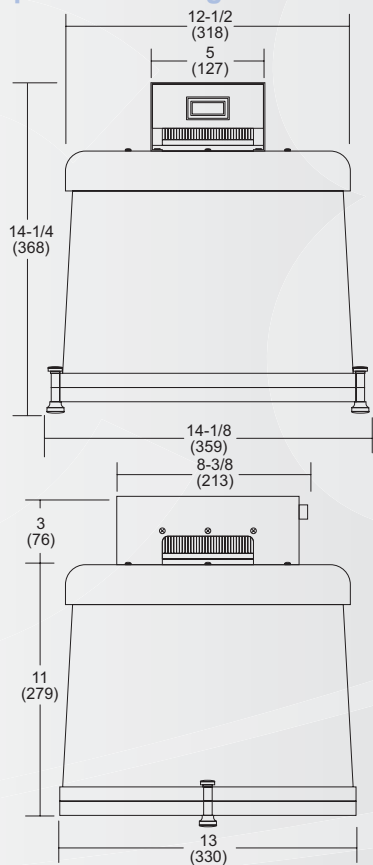

Remote Power Supply

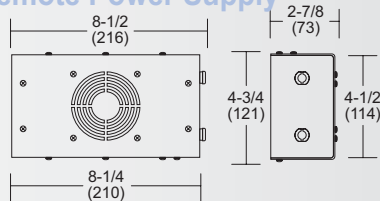

POP-CC1004
CC IC Banner Kit
3' x 4'
MSRP \$27.25



POP-CC1003
CC IC Table Tents
5" x 7" per panel
MSRP \$21.70 (pkg 25)



POP-CC1001
CC IC Small Poster
8.5" x 11"
MSRP \$17.35 (pkg 50)

POP-CC1002
CC IC Large Poster
18" x 24"
MSRP \$33.60 (pkg 25)



POP-CC1008
CC IC Badges
8.5" x 11"
MSRP \$3.75



POP-CC1009
CC IC Menu Display Kit
N/A - Excludes Candies
MSRP \$45.00



POP-CC1005
CC IC Lightbox Kit
16" x 20" x 4.75"
MSRP \$109.20

POP-CC1005D
CC IC Trans
16" x 20"
MSRP \$44.50



POP 7036
Acrylic Display Frame
8.5" x 11"
MSRP \$7.70



POP-CC1006
CC IC Menu Lightbox Kit
16" x 20" x 4.75"
MSRP \$109.20

POP-CC1006D
CC IC Menu Trans
16" x 20"
MSRP \$44.50



POP 6025
Mobile Bracket Kit
N/A
MSRP \$4.00



POP-CC1009P
CC IC Menu Poster
8.5" x 11"
MSRP \$8.00



MIS 3167
Menu Panel Kit
(Includes Labels)
N/A
MSRP \$24.00



POP-CC1007
CC IC Mobile Kit
18" di. x 24"
MSRP \$9.35



POP-CC1022
CC 3-Pocket Apron
N/A
MSRP \$28.00

POP-CC1017
CrunchiCreme POP Kit
Includes:
POP-CC1001 (5)
POP-CC1002 (16)
POP 7036 (1)
POP-CC1009P (1)
POP-CC1003 (1 set)
POP 6025 (4)
POP-CC1004 (1)
POP-CC1008 (1 set)
POP-CC1018 (3 sets)
MSRP \$126.00

HERSHEY'S MINI CHIPS	M&M'S
MINI REESE'S PEANUT BUTTER CUPS	HERSHEY'S MINI CHIPS
HERSHEY'S ENGLISH TOFFEE	MINI REESE'S PEANUT BUTTER CUPS
OREO	HERSHEY'S ENGLISH TOFFEE
RAINBOW REESE'S	OREO
REDFUR CUPCAKE	RAINBOW REESE'S
RAINBOW CHOCOLATE	REDFUR CUPCAKE
BUTTER FINGER	RAINBOW CHOCOLATE
WINTERGREEN MINT	BUTTER FINGER
BLUE MINT	WINTERGREEN MINT

POP-CC0108
CC8 Ingredient Labels
8.5" x 11"
MSRP \$3.75 (pkg 2)

HERSHEY'S MINI CHIPS	MINI REESE'S PEANUT BUTTER CUPS
HERSHEY'S ENGLISH TOFFEE	OREO
RAINBOW REESE'S	REDFUR CUPCAKE
RAINBOW CHOCOLATE	BUTTER FINGER
WINTERGREEN MINT	BLUE MINT

MIS 3167-L
MIS 3167
Ingredient Labels
7.5" x 10.5"
MSRP \$5.00

Flavor Burst Company has developed an extensive line of point-of-purchase (POP) materials to support local marketing and promotions. The items shown are available at the time of printing and more items are already on the way!

All pricing reflects the Manufacturer's Suggested Retail Price (MSRP) in U.S. Dollars for individual pieces unless otherwise noted by the package

count following the MSRP.

For light box displays, the transparency signage may also be purchased separately. Otherwise, the 'light box kit' includes both the specified transparency and the lighted box assembly.

Flavor Burst Company offers many 'limited edition' items within the promotional lineup. These are noted by the **LE** icon, and may be

available by special order or in limited supply. When ordering limited edition or special order items, it is especially important that you contact your local distributor for current pricing and availability. All products and services are subject to change without notice. Please contact your local distributor for current pricing and availability -- some items may be available in smaller quantities through your local distributor.

CrunchiCreme™



Dispense single or multi-flavor servings in any combination!

Convenience. The CC8 gently blends ingredients into soft serve as it is being dispensed, *not after*. Therefore CrunchiCreme™ can be dispensed into either a cup or a cone with ease. There is virtually no limit to the size of the serving, so even a child-size serving is now possible!

SERVE CUPS... or CONES!

Finished Serving Size: 10 oz.		
Ingredient Cost Per Package ¹	\$6.00 ²	\$15.00 ³
Servings per Package ¹	20	20
Ingredient Cost Per Serving	\$.30	\$.74
Soft Serve Cost Per Serving ⁴	.38	.38
Cup/Spoon Cost	.09	.09
Total Cost Per Serving	\$.77	\$1.21
Retail Price ⁵	\$2.33	\$2.33
Profit	\$1.56	\$1.12
Profit Margin	203%	93%

Cost analysis & estimated profit projections as follows:
¹Average package size 39 fl. oz., or 1 CC8 container.

²Competitive local pricing excluding freight.
³Highest average cost including freight.

⁴Simple Average of U.S. Domestic Pricing.
⁵National retail average price of comparable products.

Finished Serving Size: 5 oz.		
Ingredient Cost Per Package ¹	\$6.00 ²	\$15.00 ³
Servings per Package ¹	40	40
Ingredient Cost Per Serving	\$.15	\$.38
Soft Serve Cost Per Serving ⁴	.19	.19
Cake Cone Cost	.05	.05
Total Cost Per Serving	\$.39	\$.62
Retail Price ⁵	\$2.18	\$2.18
Profit	\$1.79	\$1.57
Profit Margin	456%	253%

Flexibility. Operators can also blend multiple ingredients into the same serving. Simply select flavor combinations from the keypad and dispense. Other blending methods sacrifice adequate blending in an attempt to maintain overrun. This is *NOT* the case with the new CC8. It maintains overrun and speed-of-service while blending product thoroughly and consistently in each serving.

Profitability. The CC8 offers electronic portion control, blending approximately 1/2 oz. of ingredients into a single 6 oz. finished serving. Each container holds enough ingredients to produce about 40 finished 5 oz. CrunchiCreme™ servings!

Variety. A growing selection of ingredients, including many of the most popular brands, are available through your local Flavor Burst distributor. Many of these products may already be available through local food service distributors.

What's Your Profit Story?



Finished Serving Size: 5 oz.		
Ingredient Cost Per Package	\$.	\$.
Servings per Package		
Ingredient Cost Per Serving	\$.	\$.
Soft Serve Cost Per Serving		
Cake Cone		
Total Cost Per Serving	\$.	\$.
Retail Price	\$.	\$.
Profit	\$.	\$.
Profit Margin	%	%

Additional Profit Per Serving
 Additional Servings Per Day
 Want more? Try the profit calculator at www.flavorburst.com/

©2007 Flavor Burst Company. CrunchiCreme is a registered trademark of Flavor Burst Company. All other marks are property of their respective owners, used with permission. The Heath brand and trade dress are used under license. All rights reserved.

CAUTION: BECAUSE ALL INGREDIENTS ARE DISPENSED THROUGH A COMMON ORIFICE, ALL FINISHED PRODUCTS SHOULD BE CONSIDERED AS CONTAINING NUTS.

REVOLUTIONARY

- CC-10015 Semi Sweet Lil' Mini Chips
- CC-10105 Rainbow Confetti
- CC-10065 Butterfinger Medium Grind
- CC-10095 Wintergreen Mint
- CC-10085 Nestle Chocolate Minis
- CC-10035 Heath Medium Heath Toffee
- CC-10045 Cookies 'N Creme
- CC-10115 Chocolate Minis
- CC-10075 Rainbow Nerds
- CC-10025 Mini Reese's

